

**Specifications:**

**Material And Finish:**

Insulator:Nylon 6T UL94V-0 Color:Black  
 Contact:Brass  
 Plated:See Ordering Information

**Rating:**

Current Rating:1.0 Amp  
 Voltage Rating:100V AC/DC  
 Operating Temperature Range:-40~+105°C

**Electrical:**

Contact resistance:20m Ohm Max  
 Insulator resistance:500M ohm min.  
 Withstanding Voltage:500V AC/Minute

**Ordering Information**

**27541S-XXX104-X**  
 1 2 3 4 5

- 1: — Series No.
- 2: — S: Straight Type
- 3: — No. of Positions
- 4: — A: Gold Flash

D:10u"Gold on Contact;Gold Flash on tail  
 F:20u"Gold on Contact;Gold Flash on tail  
 H:Gold Flash on Contact;Matte Tin on tail  
 T:10u"Gold on Contact;Matte Tin on tail  
 Y:30u"Gold on Contact;Matte Tin on tail.  
 S:Matte Tin Plated.

- 5: — A: In bag
- B: Tube
- C: Tray

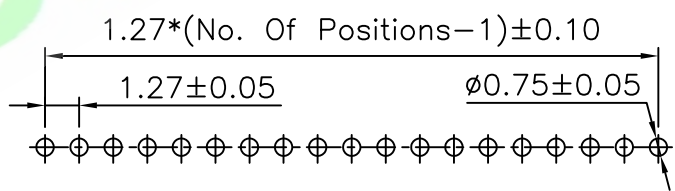
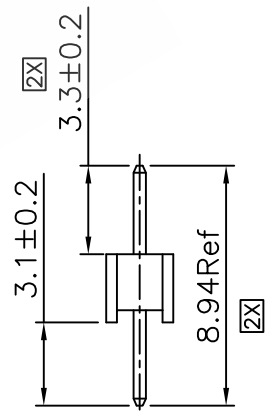
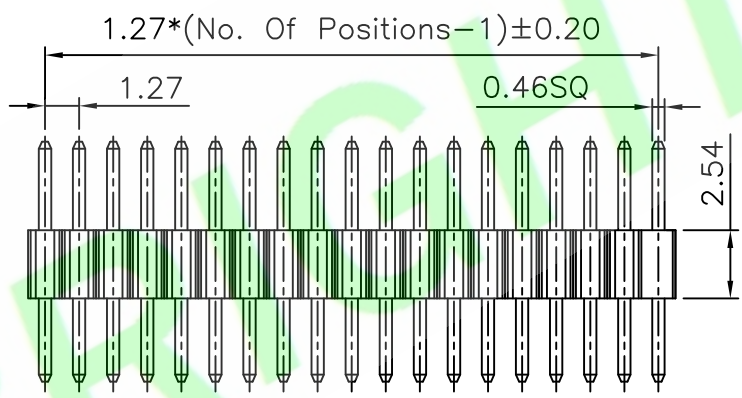
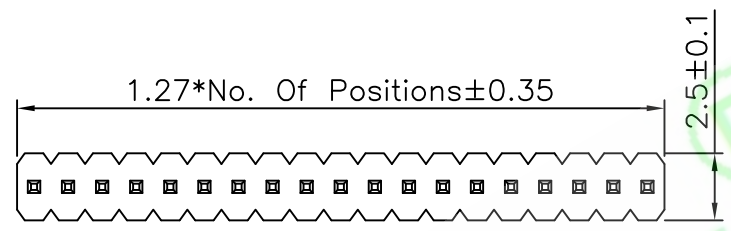

Recommended PCB Layout

|      |                    |        |          |
|------|--------------------|--------|----------|
| 5X   |                    |        |          |
| 4X   |                    |        |          |
| 3X   |                    |        |          |
| 2X   | 依客户要求尺寸由4.79变更为3.3 | Aaron  | 20181013 |
| 1X   | ORIGINAL           | Samson |          |
| REV. | DESCRIPTION        | DR.BY  | ECN. NO. |

|                   |                    |               |
|-------------------|--------------------|---------------|
| DR.BY.:<br>Samson | GENERAL TOLERANCE: |               |
| CHKD.:<br>Tony    | LINEAR             | ANGLES        |
| APPD.:<br>Billy   | X.: ±0.30          | X': ±5.0°     |
|                   | X.X: ±0.20         | X.X': ±3.0°   |
|                   | X.XX: ±0.15        | X.XX': ±2.0°  |
|                   | X.XXX: ±0.10       | X.XXX': ±1.0° |

|  |
|--|
| PART NO : 27541S-XXX104-X                        |
| DWG. NO.: RD1112-008                             |
| TITLE :<br>1.27mm Pitch Pin Header Straight Type |
| DATE: 24-Dec-2011                                |

**HJBRIGHT** 东莞市華晶電子有限公司  
 BRIGHT-E ELECTRONIC TECHNOLOGY LIMITED

SHEET: 1/1  
 SCALE: 1:1  
 UNIT: mm

THIRD ANGLE PROJECTION

**A4**