

Specifications:

Material And Finish:

Insulator:LCP UL94V-0 Color:Black
 Contact:Phosphor Bronze
 Plated:See Ordering Information

Rating:

Current Rating:3.0 Amp
 Voltage Rating:250V AC/DC
 Operating Temperature Range:-40~+105°C

Electrical:

Contact resistance:20m Ohm Max
 Insulator resistance:1000M ohm min.
 Withstanding Voltage:500V AC/Minute

Ordering Information

S25411S-XXX85-CX

1 2 3 4 5

- 1: — Series No.
- 2: — S: Straight Type
- 3: — No. of Positions
- 4: — A: Gold Flash
 D: Contact Area: Gold 10u"; Solder tail: Gold Plated
 F: D: Contact Area: Gold 20u"; Solder tail: Gold Plated
 H: Contact Area: Gold Plated; Solder tail: Tin Plated.
 P: Contact Area: Gold 30u"; Solder tail: Tin Plated.
 Q: Tin Plated
- 5: — A: In bag
 B: In Tube
 C: In Tray

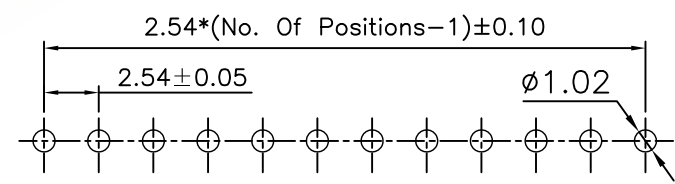
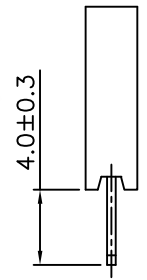
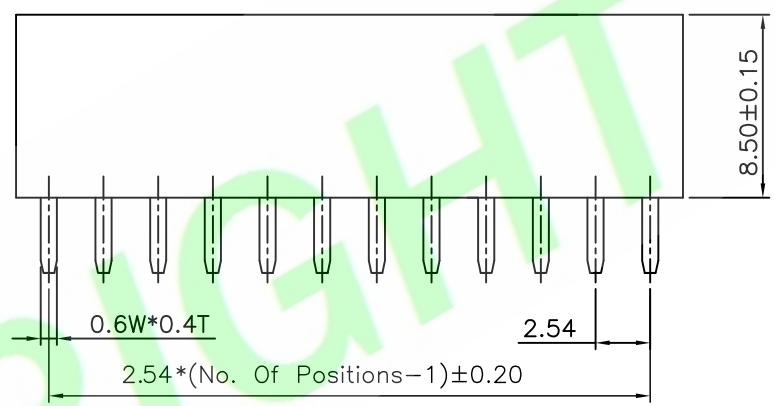
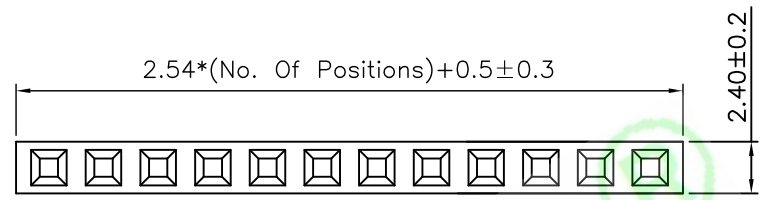

Recommended PCB Layout

5X				DR.BY.: Samson	GENERAL TOLERANCE:		PART NO : S25411S-XXX85-CX	
4X				CHKD.: Tony	LINEAR	ANGLES	DWG. NO.:	
3X					X.: ±0.30	X': ±5.0°	TITLE : 2.54mm Pitch PCB	
2X				APPD.: Billy	X.X: ±0.20	X.X': ±3.0°	Socket Header Straight Type	
1X	ORIGINAL	Samson			X.XX: ±0.15	X.XX': ±2.0°	DATE: 19-Nov-2013	
REV.	DESCRIPTION	DR.BY	ECN. NO.		X.XXX: ±0.10	X.XXX': ±1.0°	SHEET: 1/1	

HJBRIGHT 東莞市華晶電子有限公司
 BRIGHT-E ELECTRONIC TECHNOLOGY LIMITED

SHEET: 1/1
 SCALE: 1:1
 UNIT: mm

THIRD ANGLE PROJECTION

A4