

Specifications:

Material And Finish:

Insulator:PBT&PA6T&LCP UL94V-0;Color:Black

Contact:Brass

Plated:See Ordering Information

Rating:

Current Rating:3.0 Amp

Voltage Rating:250V AC/DC

Operating Temperature Range:-40~+105°C

Electrical:

Contact resistance:30m Ohm Max

Insulator resistance:1000M ohm min.

Withstanding Voltage:500V AC/Minute

Ordering Information

B2541S-XXX-XX-XX-X

1 2 3 4 5 6 7 8

1: Series No.

2: S: Straight Type

3: No. of Positions

4: A: Gold Flash

C: Gold 5u"

D: Gold 10u"

E: Gold 15u"

F: 20u" Gold on Contact; Gold Flash on tail

H: Selective Gold Plated

J: 1u" Gold

Q: Tin Plated

Y: 30u" Gold on contact; Matte Tin on tail

S: Matte Tin Plated.

T: 10u" Gold on Contact; Matte Tin on tail

5: A Size:

01=3.20mm 02=2.92mm 03=4.19mm

04=2.80mm 05=3.05mm 06=3.50mm

07=2.50mm 08=3.30mm 09=3.10mm

6: N: PA6T UL94V-0 P: PBT UL94V-0

C: LCP UL94V-0

7: A: In bag

B: In Tube

C: In Tray

8: GA: Gary

(This code blank indicates black)

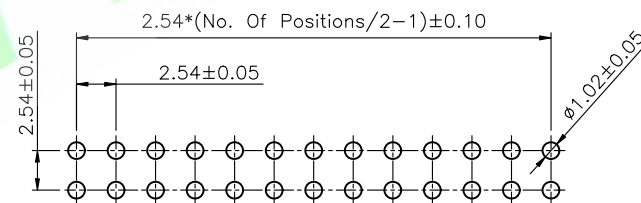
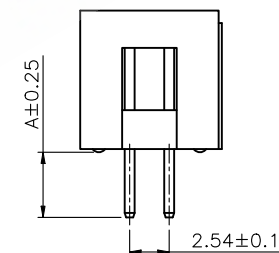
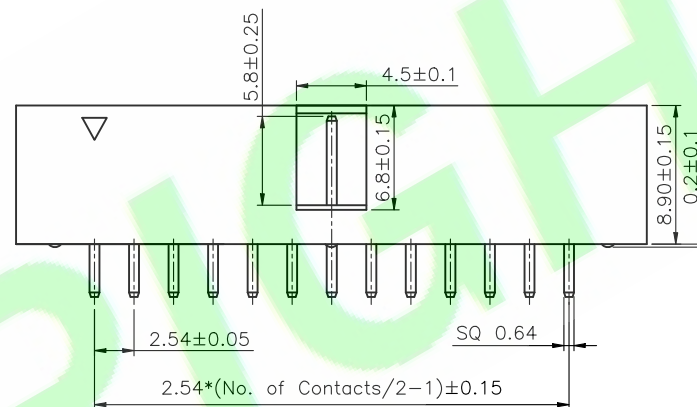
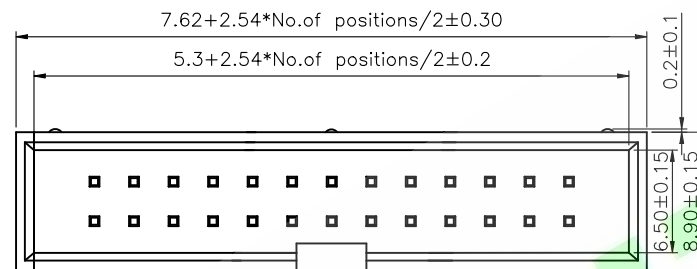

Recommended PCB Layout

|      |             |       |          |
|------|-------------|-------|----------|
| 1X   | ORIGINAL    | TSW   |          |
| REV. | DESCRIPTION | DR.BY | ECN. NO. |

|        |                    |              |                              |
|--------|--------------------|--------------|------------------------------|
| DR.BY: | GENERAL TOLERANCE: |              | PART NO : B2541S-XXX-XX-XX-X |
| Tsw    | LINEAR             | ANGLES       | DWG. NO.: RD0805-096         |
| CHKD.: | X.: ±0.30          | x.: ±5.0°    | TITLE : 2.54mm Pitch         |
| Ren    | x.x: ±0.20         | x.x: ±3.0°   | Box Header Straight Type     |
| APPD.: | x.xx: ±0.15        | x.xx: ±2.0°  | DATE: 8-Aug-2020             |
| Billy  | x.xxx: ±0.10       | x.xxx: ±1.0° |                              |

|   |          |  |           |
|---|----------|--|-----------|
| 東莞市華晶電子有限公司<br>BRIGHT-E ELECTRONIC TECHNOLOGY LIMITED |          |  | <b>A4</b> |
| SHEET: 1/1  | UNIT: mm |  |           |
| SCALE: 1:1  |          |  |           |