

Specifications:

Material And Finish:

Insulator:LCP UL94V-0
 Contact:Copper alloy
 Plated:See Ordering Information

Rating:

Current Rating:12.0 Amp
 Voltage Rating:250V AC/DC
 Operating Temperature Range:-55~+150°C

Electrical:

Contact resistance:20m Ohm Max
 Insulator resistance:1000M ohm min.
 Withstanding Voltage:1000V AC/Minute

Ordering Information

M2540H-06H-XX-D-E4

1 2 3 4 5 6 7

- 1: — Series No.
- 2: — H:Horizontal SMT Type
- 3: — No. of Positions
- 4: — S:Matte Tin on tail
 H:Gold flash on contact;
 Matte Tin on tail
- 5: — 01:A Type White
 02:B Type Red
 03:C Type Green
 04:D Type Blue
 05:E Type Black
- 6: — D:Tape&Reel
- 7: — E4:Empaty 4P

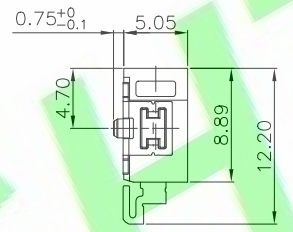
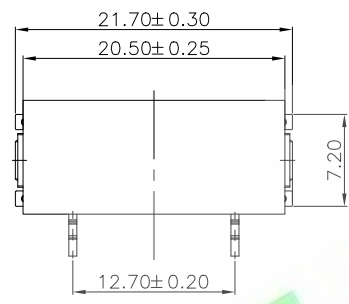
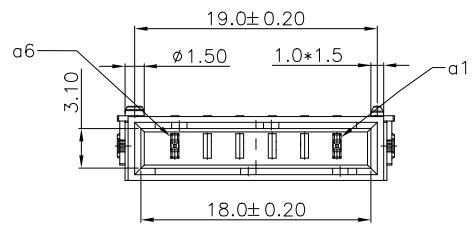

Empaty 2, 3, 4, 5

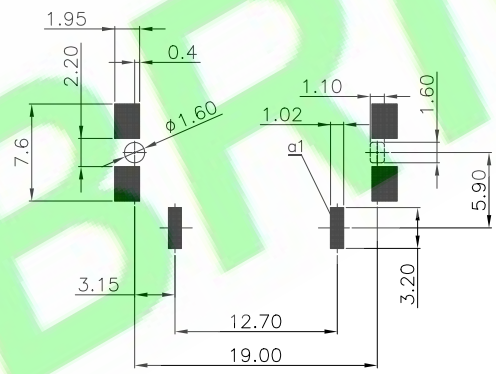

Recommended PCB Layout

A type White	B type Red	C type Green
D type Blue	E type Black	

DR.BY.: xiao	GENERAL TOLERANCE:		PART NO : M2540H-06H-XX-D-E4
CHKD.: Aren	LINEAR	ANGLES	DWG. NO.:
APPD.: Billy	x.: ±0.30	x': ±5.0°	TITLE : M2.54 SRC-A Horizontal SMT Type 6P
	x.x: ±0.20	x.x': ±3.0°	DATE: 5-Sep-2021
	x.xxx: ±0.10	x.xxx': ±1.0°	

HJBRIGHT 東莞市華晶電子有限公司
 BRIGHT-E ELECTRONIC TECHNOLOGY LIMITED

SHEET: 1/1
 SCALE: 1:1
 UNIT: mm

THIRD ANGLE PROJECTION

A4

1X	ORIGINAL	Xiao	
REV.	DESCRIPTION	DR.BY	ECN. NO