

Specifications:
 Material And Finish:
 Insulator:LCP UL94V-0 Color:BLACK
 Contact:Copper alloy
 Plated:See Ordering Information

Rating:
 Current Rating:12Amp
 Operating Temperature Range:-40~+125°C

Electrical:
 Contact resistance:20m Ohm Max
 Insulator resistance:1000M Ohm min.
 Dielectric Voltage:750V AC/Minute

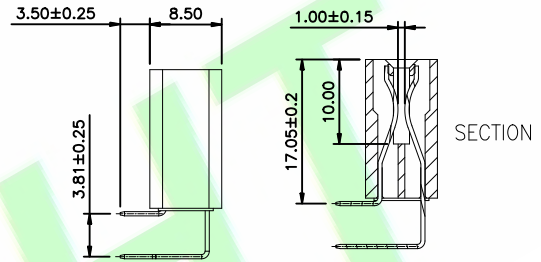
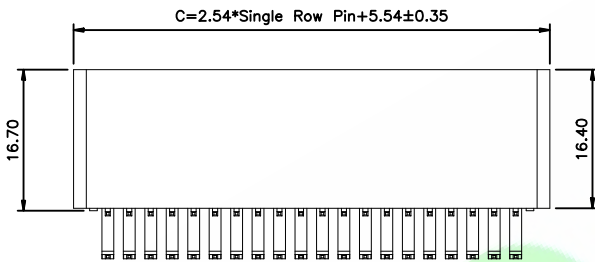
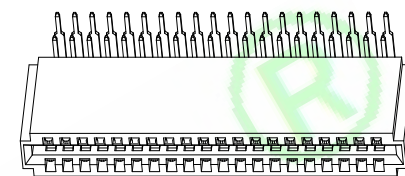
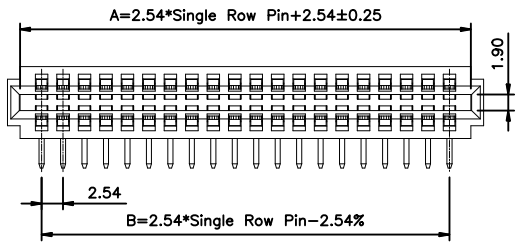

Ordering Information
 PCI2540R-XXX-01-C

- 1: Series No.
- 2: R:R/A Type
- 3: No. of Positions
- 4: A:Gold Flash
 H:Gold flash on contact;Matte Tin on tail
 I:1u" Gold on contact;Gold flash on tail
 J:3u" Gold on contact;Gold flash on tail
 C:5u" Gold on contact;Gold flash on tail
 D:10u" Gold on contact;Gold flash on tail
 K:15u" Gold on contact;Gold flash on tail
 P:30u" Gold on contact;Gold flash on tail
- 5: C:In Tray

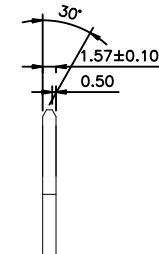
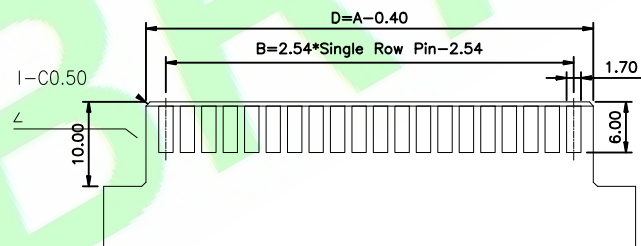
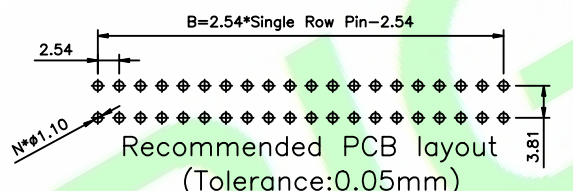

No. OF PIN	Dimensions(mm)			No. OF PIN	Dimensions(mm)		
	A	B	C		A	B	C
06	10.16	5.08	13.16	52	68.58	63.50	71.58
08	12.70	7.62	15.70	54	71.12	66.04	74.12
10	15.24	10.16	18.24	56	73.66	68.58	76.66
12	17.78	12.70	20.78	58	76.20	71.12	79.20
14	20.32	15.24	23.32	60	78.74	73.66	81.74
16	22.86	17.78	25.86	62	81.28	76.20	84.28
18	25.40	20.32	28.40	64	83.82	78.74	86.82
20	27.94	22.86	30.94	66	86.36	81.28	89.36
22	30.48	25.40	33.48	68	88.90	83.82	91.90
24	33.02	27.94	36.02	70	91.44	86.36	94.44
26	35.56	30.48	38.56	72	93.98	88.90	96.98
28	38.10	33.02	41.10	74	96.52	91.44	99.52
30	40.64	35.56	43.64	76	99.06	93.98	102.06
32	43.18	38.10	46.18	78	101.60	96.52	104.60
34	45.72	40.64	48.72	80	104.14	99.06	107.14
36	48.26	43.18	51.26	82	106.68	101.60	109.68
38	50.80	45.72	53.83	84	109.22	104.14	112.22
40	53.34	48.26	56.34	86	111.76	106.68	114.76
42	55.88	50.80	58.88	88	114.30	109.22	117.30
44	58.42	53.34	61.42	90	116.84	111.76	119.84
46	60.96	55.88	63.96	92	119.38	114.30	122.38
48	63.50	58.42	66.50	94	121.92	116.84	124.92
50	66.04	60.96	69.04	96	124.46	119.38	127.46
52	68.58	63.50	71.58	98	127.00	121.92	130.00
54	71.12	66.04	74.12	100	129.54	124.46	132.54

DR.BY.: Judyyan	GENERAL TOLERANCE:		PART NO : PCI2540R-XXX-01-C	
CHKD.: Aren	LINEAR	ANGLES	DWG. NO.:	
APPD.: Billy	x: ±0.35	x': ±5.0°	TITLE :	
	x.xx: ±0.25	x.xx': ±3.0°	2.54mm Pitch R/A Type PCI	
	x.xxx: ±0.15	x.xxx': ±1.0°	DATE: 04-Sep-2023	

HJBRIGHT® 東莞市華晶電子有限公司
 BRIGHT-E ELECTRONIC TECHNOLOGY LIMITED

SHEET: 1/1
 SCALE: 1:1
 UNIT: mm

THIRD ANGLE PROJECTION

A4

1X	ORIGINAL	Judyyan	
	DESCRIPTION	DR.BY	ECN. NO.