

Specifications:  
 Material And Finish:  
 Insulator:LCP UL94V-0 Color:BLACK  
 Contact:Copper alloy  
 Plated:See Ordering Information

Rating:  
 Current Rating:12Amp  
 Operating Temperature Range:-40~+125°C

Electrical:  
 Contact resistance:20m Ohm Max  
 Insulator resistance:1000M Ohm min.  
 Dielectric Voltage:750V AC/Minute

Ordering Information  
 PCI2540R-XXX-01-C14  
 1 2 3 4 5 6

- 1: Series No.
- 2: R/R/A Type
- 3: No. of Positions
- 4: A:Gold Flash  
 H:Gold flash on contact;Matte Tin on tail  
 I:1u" Gold on contact;Matte Tin on tail  
 E:3u" Gold on contact;Matte Tin on tail  
 B:5u" Gold on contact;Matte Tin on tail  
 T:10u" Gold on contact;Matte Tin on tail  
 L:15u" Gold on contact;Matte Tin on tail  
 Y:30u" Gold on contact;Matte Tin on tail
- 5: C:In Tray
- 6: 14:Empty 14PIN

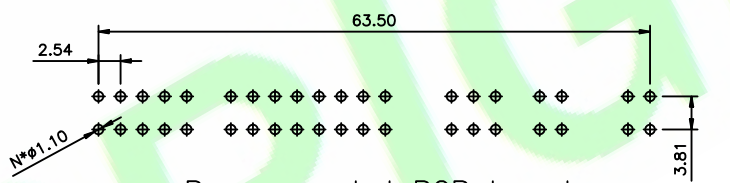
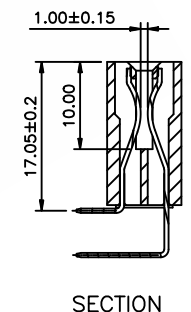
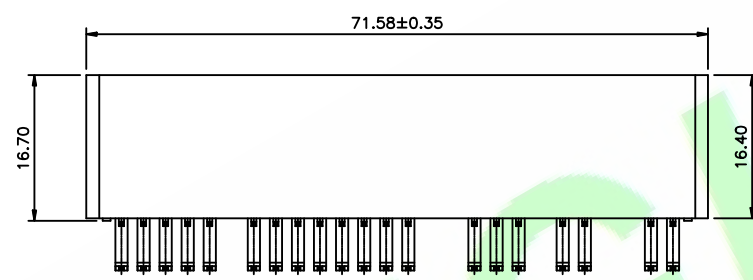
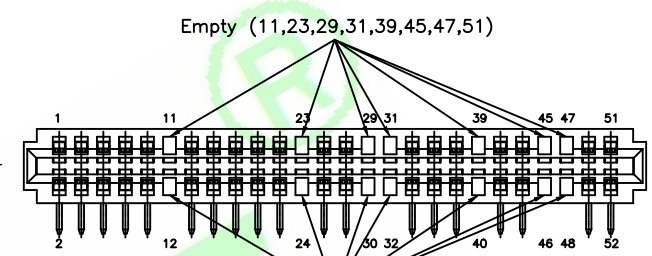
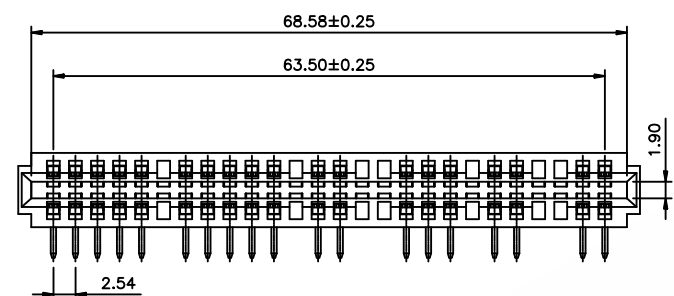

Recommended PCB layout  
 (Tolerance:0.05mm)

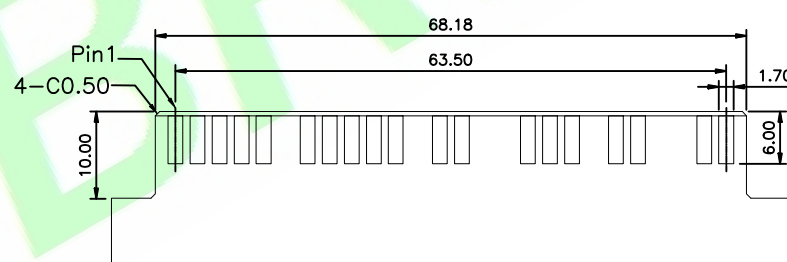

Recommended Plug-PCB layout  
 (Tolerance:0.05mm)

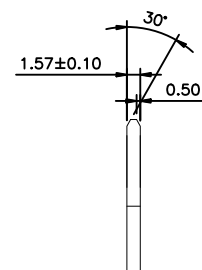

DR.BY.: Judyyan	GENERAL TOLERANCE:		PART NO : PCI2540R-XXX-01-C14
CHKD.: Aren	LINEAR	ANGLES	DWG. NO.:
APPD.: Billy	x: ±0.35	x': ±5.0°	TITLE : 2.54mm Pitch R/A Type PCI Empty 14PIN
	x.xx: ±0.25	x.xx': ±2.0°	DATE: 10-Sep-2025
	x.xxx: ±0.15	x.xxx': ±1.0°	

**HJBRIGHT**® 東莞市華晶電子有限公司  
 BRIGHT-E ELECTRONIC TECHNOLOGY LIMITED

SHEET: 1/1  
 SCALE: 1:1  
 UNIT: mm

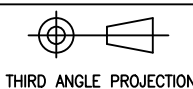

**A4**

1X	ORIGINAL	Judyyan	
	DESCRIPTION	DR.BY	ECN. NO.